

GABLED ROOF

CONCRETE AND MASONRY SUPPORT – ROOF TILE PROTECTIVE COVER

Para. 1

Concrete and masonry slanting slab.

Before laying the membrane, treat the entire surface of the screed that comprises waterproof, as well as the overlaps, with **PRIMER V 70**, applying this at a rate of $200 \div 300 \text{ g/m}^2$, and in any case using a sufficient quantity to ensure adherence of the waterproof membrane.

Para. 2

A) Vapour control layer (EN 13707) for environments with relative humidity $< 70\%$ in bituminous and plasto-elastomeric based waterproofing membrane with strengthened surfacing mat **ISOLVAPOR NB VV** (vapour diffusion resistance factor $\mu > 40.000$) full adherence heat stretched and carefully welded to the overlaps.

The particular structure of the upper **ISOLVAPOR NB** face made up of "ashlar" elements linked to the particular bituminous mix, allows for the use of the vapour barrier below the insulating element.

B) Vapour barrier (EN 13970) for environments with relative humidity $< 70\%$ in bituminous and plasto-elastomeric based waterproofing membrane strengthened with aluminium embossed foil **ISOLVAPOR NB VV** (vapour diffusion resistance factor $q > 500.000$) full adherence heat stretched and carefully welded to the overlaps.

The particular structure of the upper **ISOLVAPOR NB** face made up of "ashlar" elements linked to the particular bituminous mix, allows for the use of the vapour barrier below the insulating element.

Para. 3

Separation layer in a heavy work site polyethylene sheet or insulating supporting strips.

Para. 4

Insulating system obtained with the continuous coupling of a specific elastoplastomer polymer bitumen membrane with polyurethane foam panels (**NORDPOL PUR**) or EPS 150 sintered XPS (**NORDPOL EPS**) or self-extinguishing extruded (**NORDPOL XPS**).

The elastoplastomer polymer bitumen membrane (BPP), applied to the panel, will be smooth with polyester non-woven fabric reinforcement (POL) or layer of strengthened surfacing mat (VV).

The geometric conditions and trend of local gradients, with one of the following frameworks: staggered longitudinal joints, staggered transversal joints, angular joints and with joints which are, in any case, properly placed alongside each other and well levelled.

The installation of panels on the vapour screen or vapour barrier should be done by carefully placing each panel in juxtaposition to adjacent panels; the panels will adhere effectively and safely to the **ISOLVAPOR NB** for simple heat tempering of the upper ashlar face of the membrane, previously placed on the installation level.

The thickness of the insulating system should comply with current legal standards for energy saving in buildings and should be of a suitable size to avoid the dew point being below the vapour barrier.

Para. 5

Gutter in , length cm, attached to the head strip with nails or screws.

Fastening arm of the gutter attached to the head strip with nails or dowels.

Drainpipe in and 8/10 mm thick, diameter cm

Para. 6

NB polymer modified bitumen mineral membrane, (reinforced with spunbound polyester non-woven fabric, reinforced composite, self-protecting reinforcement with chips of natural slate, installed in sufficient quantity and in the same direction as the basic membrane but with staggered longitudinal joints (that is, laying the canvases of the 2nd layer straddling the 1st one), completely adhering and carefully welded on the overlaps (minimum overlapping: 80 mm side and 150 mm butt - minimum actual adhesion: 60 mm side and 100 mm butt - for butt joints, a maximum overlapping of three canvases will be allowed) and in correspondence with all the perimeter details.

Para. 7

Sealing protective roof tile cover
type , dimensions cm x cm.

GABLED ROOF

CONCRETE AND MASONRY SUPPORT – ROOF TILE PROTECTIVE COVER

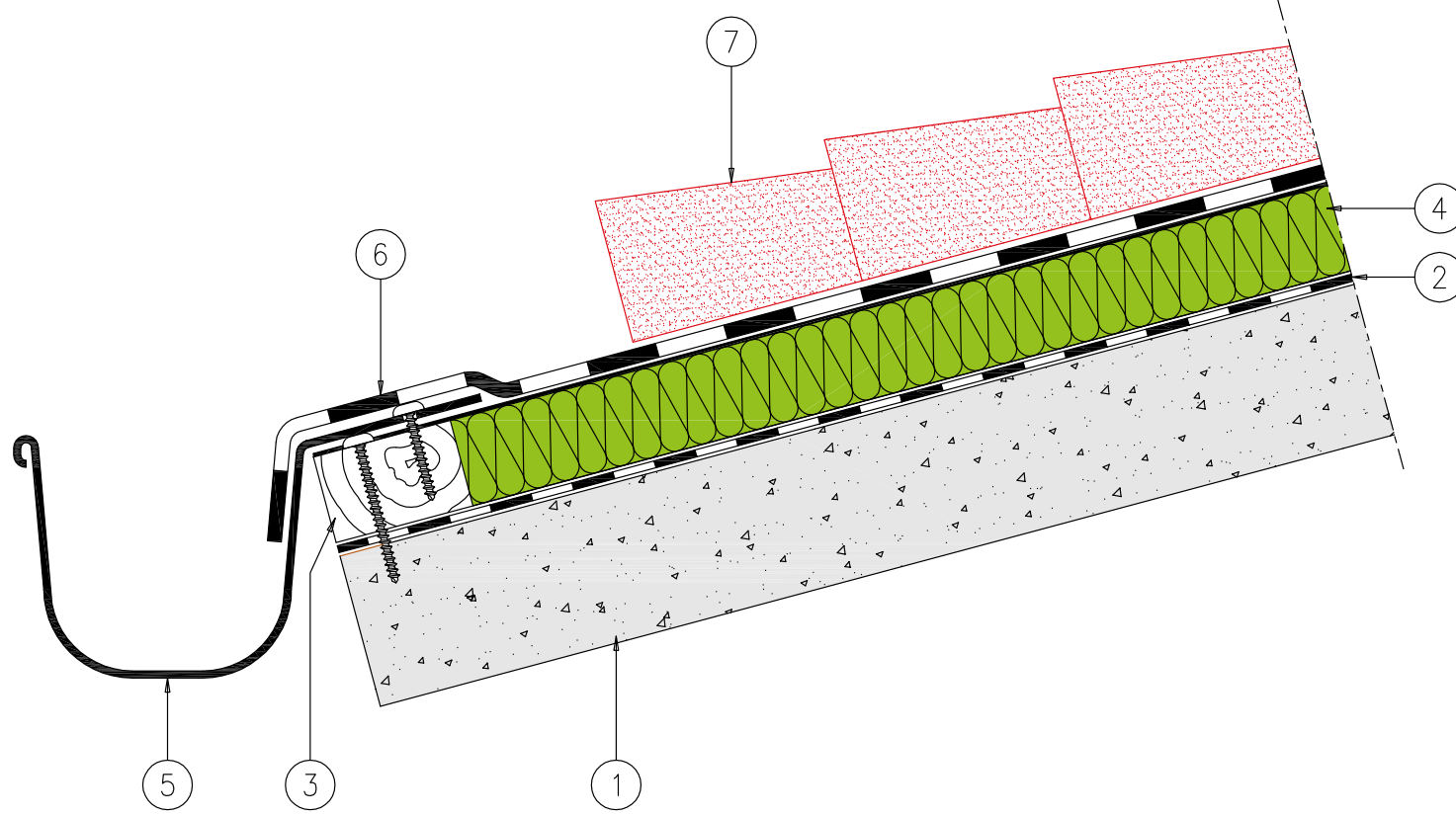

1. Support treated with Primer V70
2. Isolvapor NB vapour screen/barrier
3. Mechanically attached wooden profile
4. Nordpol coupled heat insulating element
5. Mechanically attached gutter
6. NB polymer modified mineral bitumen cap sheet membrane
7. Shingle or roof tile protective cover